

RCCN 日成MWS型夹线套 Narrow Wire Saddle-Arrowhead

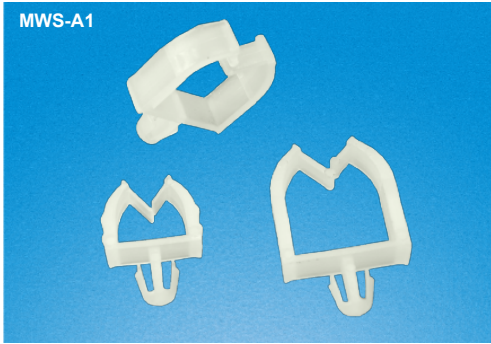

MWS-A1

材质：UL合格之NYLON66(本色)，防火等级94V-2，绝缘性佳，不易老化。
 本品与MWS-A1/B1系列区别是开孔3.5。
 Material：UL approved NYLON66(natural)，fireproof 94V-2，
 good insulation,good aging resistant.
 The difference between this product abd MWS-1A/B1 lies in the hole is 3.5

单位/Unit:mm

| 型号 Item No. | A | B | 孔径 Hole dia. | 板厚 Board thickness | 包装 Packing |
|----------------|------|-----|-----------------|-----------------------|---------------|
| MWS-A-7.3 | 7.3 | 6.7 | 3.0 | 1.6 | 1000pcs |
| MWS-A-9.1 | 9.1 | 8.2 | 3.0 | 1.6 | |
| MWS-A-11.2 | 11.2 | 9.4 | 3.0 | 1.6 | |
| MWS-A-13.0 | 13.0 | 9.4 | 3.0 | 1.6 | |
| MWS-B-7.3 | 7.3 | 6.7 | 3.0 | 2.4 | |
| MWS-B-9.1 | 9.1 | 8.2 | 3.0 | 2.4 | |
| MWS-B-11.2 | 11.3 | 9.4 | 3.0 | 2.4 | |
| MWS-B-13.0 | 13.0 | 9.4 | 3.0 | 2.4 | |

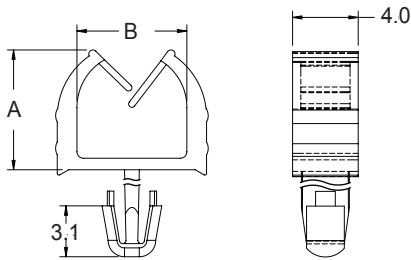

单位/Unit:mm

| 型号 Item No. | A | B | 孔径 Hole dia. | 板厚 Board thickness | 包装 Packing |
|----------------|------|-----|-----------------|-----------------------|---------------|
| MWS-A2-7.3 | 7.3 | 6.7 | 3.5 | 1.6 | 1000pcs |
| MWS-A2-9.1 | 9.1 | 8.2 | 3.5 | 1.6 | |
| MWS-A2-11.2 | 11.2 | 9.4 | 3.5 | 1.6 | |
| MWS-A2-13.0 | 13.0 | 9.4 | 3.5 | 1.6 | |
| MWS-B2-7.3 | 7.3 | 6.7 | 3.5 | 2.4 | |
| MWS-B2-9.1 | 9.1 | 8.2 | 3.5 | 2.4 | |
| MWS-B2-11.2 | 11.3 | 9.4 | 3.5 | 2.4 | |
| MWS-B2-13.0 | 13.0 | 9.4 | 3.5 | 2.4 | |

RCCN 日成NWS/LWS型夹线套 Narrow Wire Saddle-Arrowhead

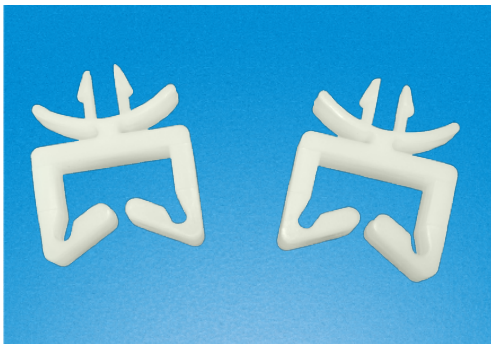

单位/Unit:mm

| 型号 Item No. | A | 孔径 Hole dia. | 板厚 Board thickness | 包装 Packing |
|----------------|------|-----------------|-----------------------|---------------|
| NWS-13 | 13.0 | 4.8 | 1.6 | 1000pcs |
| NWS-18 | 18.0 | 4.8 | 1.6 | |
| NWS-26.9 | 26.9 | 4.8 | 1.6 | |
| NWS-34.8 | 34.8 | 4.8 | 1.6 | |

| 型号 Item No. | A | 孔径 Hole dia. | 板厚 Board thickness | 包装 Packing |
|----------------|------|-----------------|-----------------------|---------------|
| LWS2-13.0 | 13.0 | 4.8 | 1.6 | 1000pcs |
| LWS2-18.0 | 18.0 | 4.8 | 1.6 | |
| LWS2-27.2 | 27.2 | 4.8 | 1.6 | |
| LWS2-35.1 | 35.1 | 4.8 | 1.6 | |

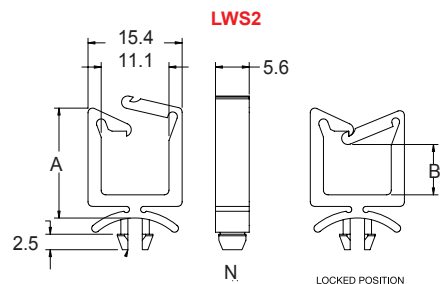
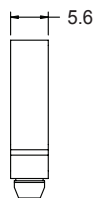
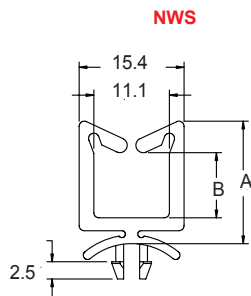

日成MWS型NWS型LWS型夹线套

Narrow Wire Saddle-Arrowhead